

UPPER WALL FRAME LAYOUT

CEILING HEIGHT - 2700mm

STRUCTURAL DETAILS

T # B PLATES 90x35 MGP10 UNO
EXTERNAL STUDS 90x35 MGP10 @ 600 CTS UNO
STUDS POSITIONED DIRECTLY BENEATH RAFTER/TRUSSES
@ MAX 600MM CTS
INTERNAL STUDS 90x35 MGP10 @ 600 CTS UNO
STRUTS BLOCKED OVER 2 SINGLE 90x45 MGP10 STUDS
BLOCKING 90x70 MGP10
NOGGING 90x35 PINE @ 1350 MAX CTS
1/90x35 MGP10 DIRECTLY BENEATH INTERNAL SUPPORT
ALL STRUCTURAL MATERIAL TO BE MGP10, UNO.
JOINT GROUP=JD5
ALL MATERIALS ALLOWED AS PER AS 1684.2-2010
NON-LOAD BEARING WALLS UNDER
TRUSSES SET DOWN 20mm

ROOF COVERING :

ROOF PITCH :

CEILING HEIGHT :

OVERHANG :

C/BOND

20 deg

2700 mm

450 mm

STUDS AT SIDES OF OPENINGS

AND POINT LOAD STUDS
AS SHOWN BELOW

△ = 1/90x45 MGP10

X = 2/90x35 MGP10

□ = 2/90x45 MGP10

D7

D6

D5

D4

S:\OAKRIDGE TAKEOFFS\D\ANDREA\50-52 WINDSOR ST\DWLG 4-7\DWLG 4-7.dwg

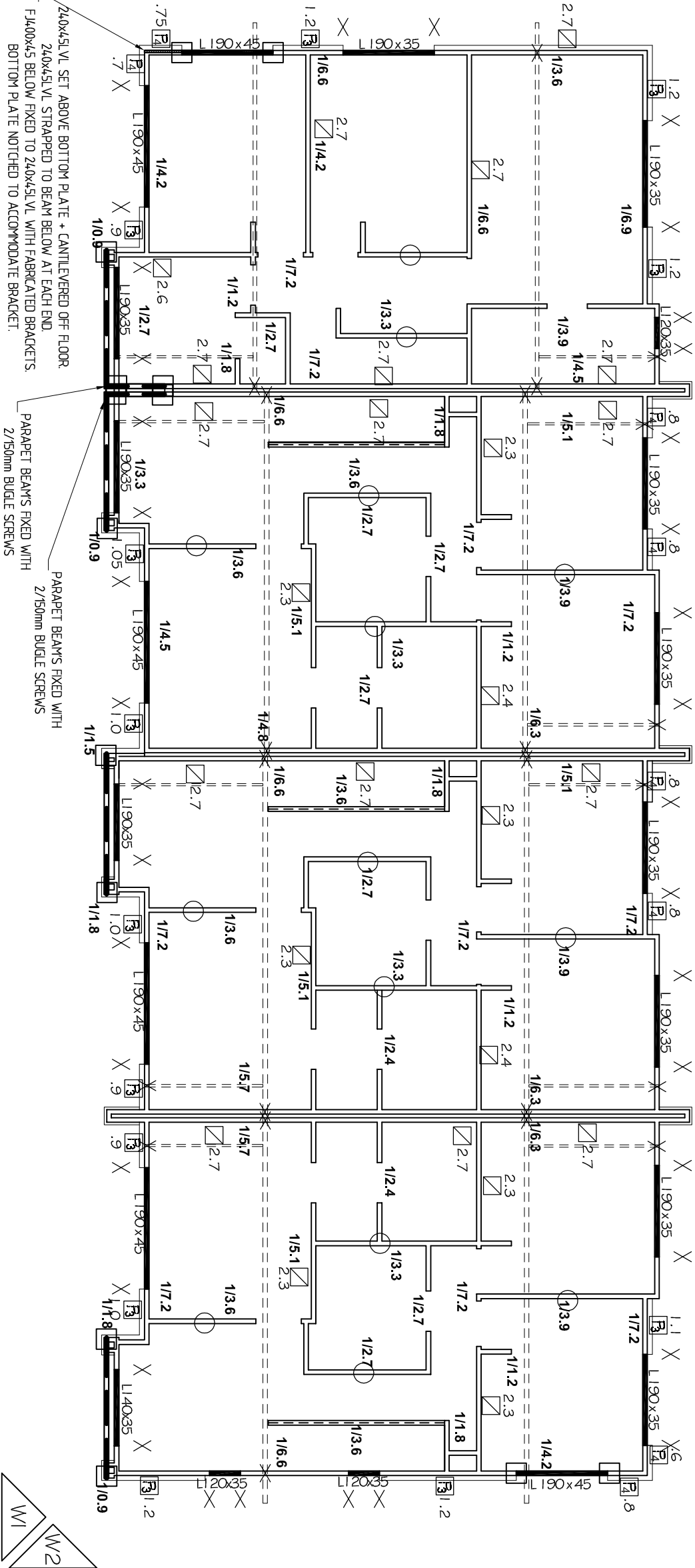

TOP PLATE FIXING DETAILS - PARALLEL TO WALL
- TABLE B.22 (C)

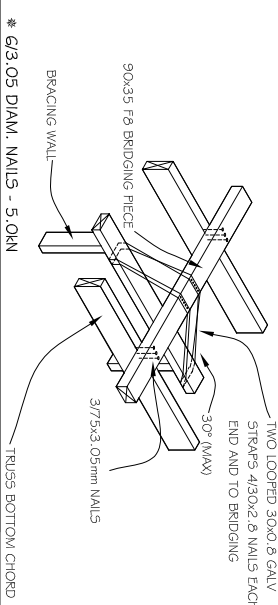

* 6/3.05 DIAM. NAILS - 5.0kN

TOP PLATE FIXING DETAILS - PERP. TO WALL

- TABLE B.22 (I)

INTERNAL WALL BRACKET NAILED AT TOP OF SLOTT. DO NOT DRIVE HOME TO ALLOW FOR VERTICAL MOVEMENT OF TRUSSES

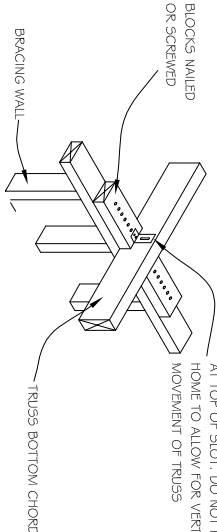

* 6/3.05 DIAM. NAILS - 5.0kN
* 3/10x1.4 TYPE 17 SCREWS - 1.0kN

BRACING UNITS

METAL ANGLE BRACE - TABLE B.18 (C)

METAL ANGLE BRACE 2/30x2.8mm GALV. NAIL5 TO EACH STUD AND PLATE

30x0.8mm GALV. STRAP 3/30x2.8mm GALV. NAILS TO EACH STUD

BOTTOM PLATE FIXED TO FLOOR AS PER TIEDOWN SHEETS

□ - 1800mm (2.7kN) □ - 2100mm (3.15kN)

□ - 2400mm (3.6kN) □ - 2700mm (4.05kN)

OS BRACE TYPE #3 | SYSTEM 6.0kN/m OR EQUIVALENT

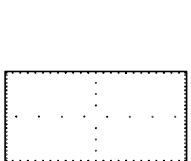

- MINIMUM SECTION OF BRACING OF 900mm
- 2mm DEBRANDON GAP AROUND PERIMETER OF EVERY PANEL
- 2.8x30mm FLAT HEAD GALVANISED OR CORROSION RESISTANT NAILS, OR THEIR GUN DRIVEN EQUIVALENT, MINIMUM OF 15mm FROM EDGE OR 8mm WHERE PANELS ARE FIXED TO INTERNAL FRAMING

□ - 900mm (5.4kN) □ - 1200mm (7.2kN)

OS BRACE TYPE #4 | SHORT WALL BRACING | SYSTEM 2.2kN/m OR EQUIVALENT

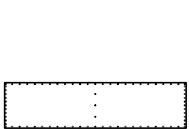

- MINIMUM SECTION OF BRACING OF 450mm
- 2mm DEBRANDON GAP AROUND PERIMETER OF EVERY PANEL
- 2.8x30mm FLAT HEAD GALVANISED OR CORROSION RESISTANT NAILS, OR THEIR GUN DRIVEN EQUIVALENT, MINIMUM OF 15mm FROM EDGE OR 8mm WHERE PANELS ARE FIXED TO INTERNAL FRAMING

□ - 450mm (1.0kN) □ - 600mm (1.3kN)

○ ADDITIONAL ANGLE BRACE

WINDSPEED (per residence) :

W1 17 m² = 11 kN

W2 29 m² = 19 kN

D\ANDREA

WP PROPERTY GROUP
50-52 WINDSOR ST, MAGILL
Detailer: Matt Opie

Signed:

Matthew Opie

AMENDMENTS

FRAMING AMENDED 14/02/2019

SHEET 3/6

DATE : 05/12/18

SCALE: 1 : 100

JOB No. T1023601/123

OAKRIDGE
BUILDING SERVICES

PH : 83837222

FAX : 83837225